

## EM1450 Mount

### WALL MOUNT, LIGHT DUTY, ENCLOSURE

#### Product Features

- Light Duty Wall Mount
- Maximum Load 9 kg (20 lb)
- For Use with EH3500 Series Enclosures
- Adjustable Head for Mechanical Positioning of the Enclosure
- Can Be Adapted for Pole Mount Applications with Use of PA101 Adapter



The **EM1450** is a light duty wall mount designed specifically for use with Pelco's EH3500 Series enclosures.

Manufactured from die-cast aluminum, the **EM1450** is capable of supporting a maximum load of 9 kg (20 lb) and can be safely mounted to any vertical load-bearing surface.

The **EM1450** features a small adjustable mounting head that is unobtrusive and provides ample clearance between the cable feedthrough glands and the mounting head.

The **EM1450** can also be adapted for pole mount applications when used with our PA101 adapter.

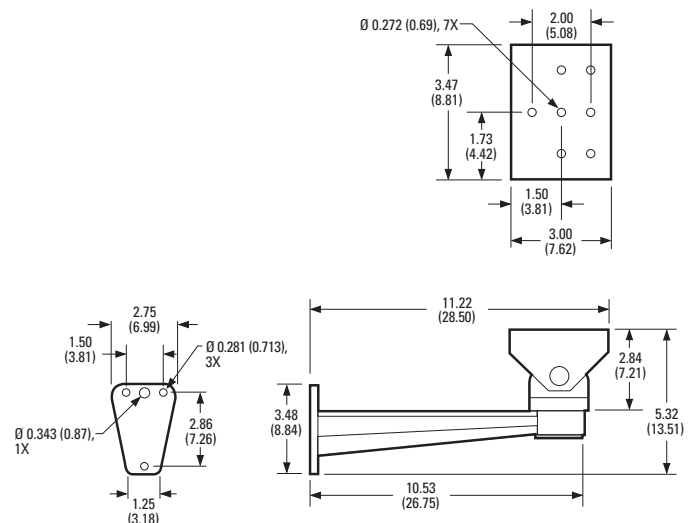

NOTE: VALUES IN PARENTHESES ARE CENTIMETERS;  
ALL OTHERS ARE INCHES.

# TECHNICAL SPECIFICATIONS

## MODEL

EM1450

Light duty wall mount for use with EH3500 series enclosures

## RELATED PRODUCT

PA101

Pole mount adapter for EM1450 mount. Stainless steel straps supplied. Straps fit 7.62 cm (3-inch) to 20.32 cm (8-inch) diameter pole.

## MECHANICAL

Pan Adjustment

360°

Tilt Adjustment

±75°

## GENERAL

Suggested

Mounting Method

Secure to wall with three 1/4-inch diameter fasteners (not supplied), or use one 5/16-inch diameter and one 1/4-inch diameter fastener for center mount holes in applications where wall studs are encountered

Enclosure Mounting

Two 1/4-20 x 0.500 hex head machine screws (supplied)

Maximum Load

9 kg (20 lb)

Construction

Die-cast aluminum

Finish

Gray polyester powder coat

Environment

Indoor/outdoor

Unit Weight

EM1450

0.90 kg (2 lb)

PA101

0.40 kg (0.88 lb)

Shipping Weight

EM1450

1.36 kg (3 lb)

PA101

0.90 kg (2 lb)

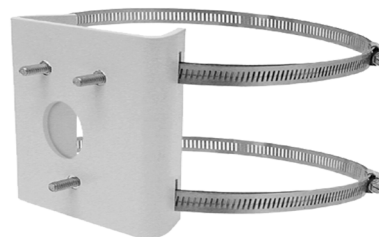

PA101 POLE ADAPTER

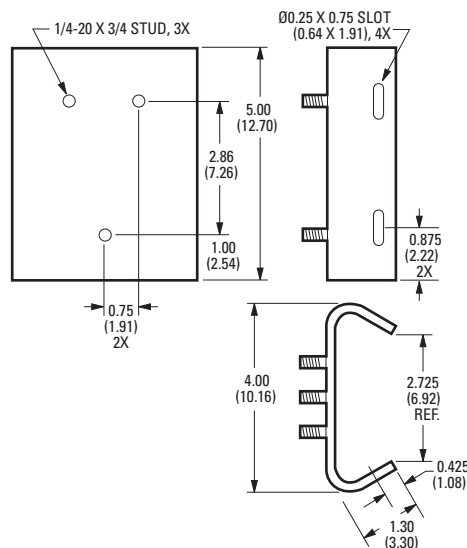

NOTE: VALUES IN PARENTHESES ARE CENTIMETERS; ALL OTHERS ARE INCHES.

## Pelco by Schneider Electric

3500 Pelco Way, Clovis, California 93612-5699 United States

**USA & Canada** Tel (800) 289-9100 Fax (800) 289-9150

**International** Tel +1 (559) 292-1981 Fax +1 (559) 348-1120

**www.pelco.com** **www.pelco.com/community**

Pelco, the Pelco logo, and other trademarks associated with Pelco products referred to in this publication are trademarks of Pelco, Inc. or its affiliates. ONVIF and the ONVIF logo are trademarks of ONVIF Inc. All other product names and services are the property of their respective companies. Product specifications and availability are subject to change without notice. ©Copyright 2015, Pelco, Inc. All rights reserved.