

HD Zoom (2000mm)

D60x16.7SR4DE-V21

60x Applicable camera (model) 1 2/3 1/1.8 1/2 1/3 1/4 For Surveillance

HD
2MP

Day
Night

VISIBLE
LIGHT
CUT

Applicable to
1/1.8

Zoom
ZOOM

Motor Drive
MOTOR DRIVE

Telephoto Long Focal
TELE

DC Auto Iris
D C

C Mount
C-mt

Metal Mount
METAL

Potentiometer
PRESET

ND Filter
N D

Extender
2 X

RoHS Compliant
RoHS

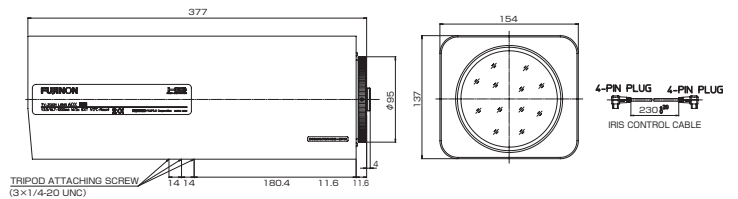

Unit : mm

D60x16.7SR4DE-V21				
Focal Length (mm)	1x	16.7 - 1000		
	2x	33.4 - 2000		
Iris Range	1x	F3.5 - F16		
	2x	F7.0 - F32		
Filter	ND (1/8, 1/64), Visible Light Cut			
Operation	Zoom	Motor Drive		
	Focus	Motor Drive		
	Iris	Auto(DC type) or Remote		
AF	N/A			
Optical Anti-Vibration	N/A			
Angle of View (H x V) (4:3) (mm)	1/1.8"	1x	WIDE	23°4' x 17°40'
			TELE	0°25' x 0°19'
		2x	WIDE	11°45' x 8°53'
			TELE	0°12' x 0°9'
	1/2"	1x	WIDE	20°51' x 15°54'
			TELE	0°22' x 0°17'
2x		WIDE	10°34' x 7°58'	
		TELE	0°11' x 0°8'	
Angle of View (H x V) (16:9) (mm)	1/1.8"	1x	WIDE	24°53' x 14°34'
			TELE	0°27' x 0°15'
		2x	WIDE	12°45' x 7°17'
			TELE	0°14' x 0°8'
	1/2"	1x	WIDE	22°33' x 13°5'
			TELE	0°24' x 0°14'
2x		WIDE	11°28' x 6°32'	
		TELE	0°12' x 0°7'	
Focus Range (From the Lens Front) (m)	∞ - 5			
Object Dimensions at M.O.D.(H x V) (4:3) (mm)	1/1.8"	1x	WIDE	1972 x 1503
			TELE	35 x 27
		2x	WIDE	995 x 27
			TELE	18 x 13
	1/2"	1x	WIDE	1780 x 1351
			TELE	32 x 24
2x		WIDE	895 x 675	
		TELE	16 x 12	
Object Dimensions at M.O.D.(H x V) (16:9) (mm)	1/1.8"	1x	WIDE	2133 x 1236
			TELE	38 x 22
		2x	WIDE	1081 x 616
			TELE	19 x 11
	1/2"	1x	WIDE	1929 x 1110
			TELE	34 x 20
2x		WIDE	972 x 553	
		TELE	17 x 10	
Back Focal Distance (in air) (mm)	24.92			
Exit Pupil Position (From Image Plane) (mm)	(1x) -448.80 (2x) -85.23			
Filter Thread (mm)	M112 x 0.75			
Mount	C			
Extender	2x			
Mass (kg)	6.4			
Standard Accessories	IRIS CONTROL CABLE			
Remarks				

