

# M5020FIC-MPIR

f=50mm F2.0 Day & Night  
for 2/3 type 5 Megapixel Cameras, Fixed-focal, Manual Iris  
C-Mount

Model No.	M5020FIC-MPIR			Effective	Front	φ 25.2mm	
Focal Length	50mm			Lens Aperture	Rear	φ 11.0mm	
Max. Aperture Ratio	1:2.0			Back Focal Length		14.8mm	
Max. Image Format	11.3mm x 6.0mm(φ 12.8mm)			Flange Back Length		17.526mm	
Operation Range	Iris	F2.0 - F16C		Mount		C-Mount	
	Focus	2m - Inf.		Filter Size		M40.5 × 0.5	
	Zoom	-		Dimensions		φ 46.5mm × 53.9mm	
Control	Iris	Manual		Weight		155.0 g	
	Focus	Manual					
	Zoom	-					
Angle of View	D	2/3 type	12.2°	1/2 type	8.9°	1/3 type	6.7°
	H		9.8°		7.1°		5.3°
	V		7.3°		5.3°		4.0°
CMV2000 11.264 × 5.984 (φ 12.75)	D	14.1°					
	H	12.5°					
	V	6.7°					
Operating Temperature	-10°C - +50°C						

## Dimensions

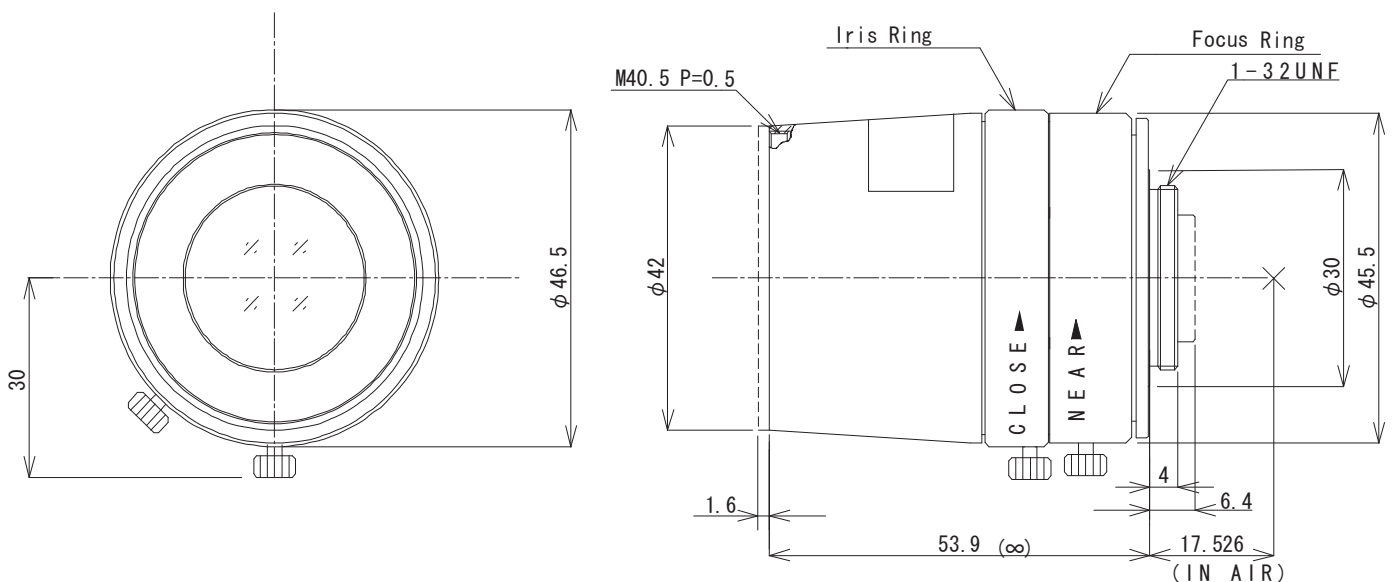

O-COMP43-06/2015 - Subject to technical change without notice. No liability is accepted for errors which may be contained in this document.